

# **CPPG 5 BP S5 50Hz 110V/220V/230V ESF s/n ESF999999 -**

Spare Parts List : Power Generators

Mechanical

Frame . . . . . 1

Engine

Engine assembly 220/110V . . . . . 3

Crankcase 220/110V . . . . . 5

Engine assembly 230V . . . . . 7

Crankcase 230V . . . . . 9

Cylinder head . . . . . 11

Flywheel assembly . . . . . 13

Muffler assembly . . . . . 15

Air cleaner assembly . . . . . 17

Carburetor assembly . . . . . 19

Fuel tank . . . . . 21

Electric system

Control panel assembly 220/110V . . . . . 23

Control panel assembly 230V . . . . . 25

Starter assembly . . . . . 27

Alternator . . . . . 29

Options

**Mechanical** Frame

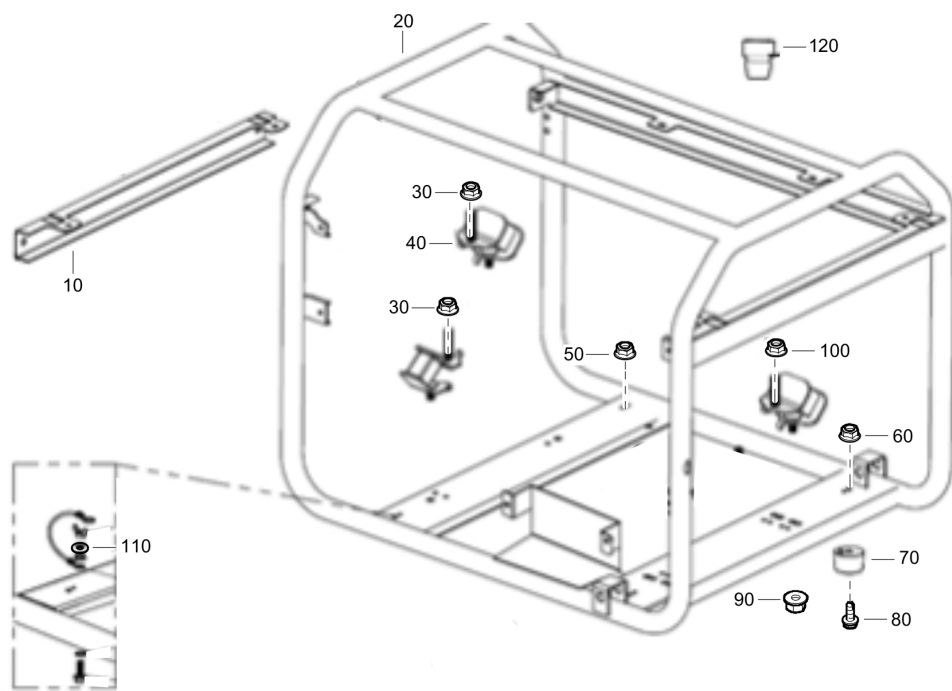

Item	Part No.	Name	Qty	L
10	1636302269	Frame girder	1	
20	1636300721	Components of frame	1	
30	1636303330	Hexagon nut with flange	4	
40	1636300722	Frame shock absorbing seat	1	
50	1636302285	Hexagon nut with flange	2	
60	1636302299	Hexagon nut with flange	2	
70	1636300656	Frame shock absorbing seat	1	
80	1636303324	Hexagon bolt with flange	3	
90	1636302283	Hexagon nut with flange	2	
100	1636300000	Hexagon nut with flange	2	
110	1636302286	Flat washer	1	
120	1636300657	Tank damping cushion	2	

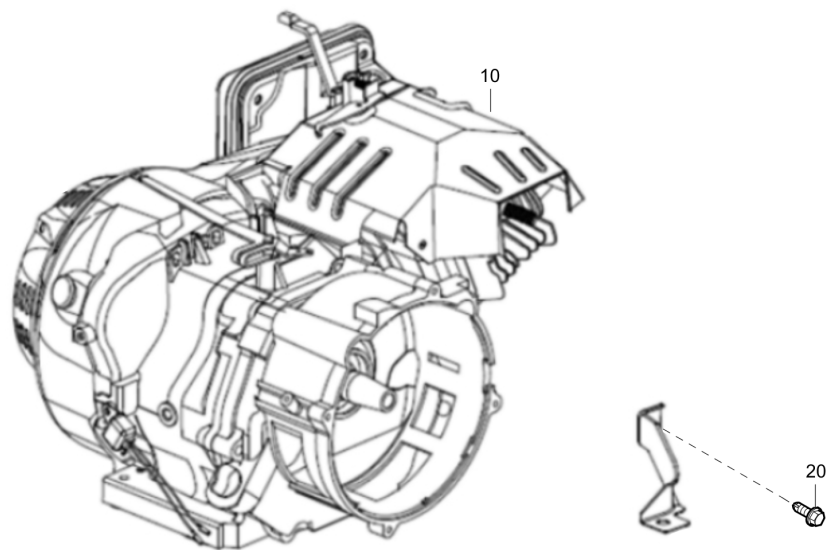

**Engine** Engine assembly 220/110V

Item	Part No.	Name	Qty	L
10	1636304206	Engine assembly	1	
20	1636302323	Hexagon bolt with flange	1	

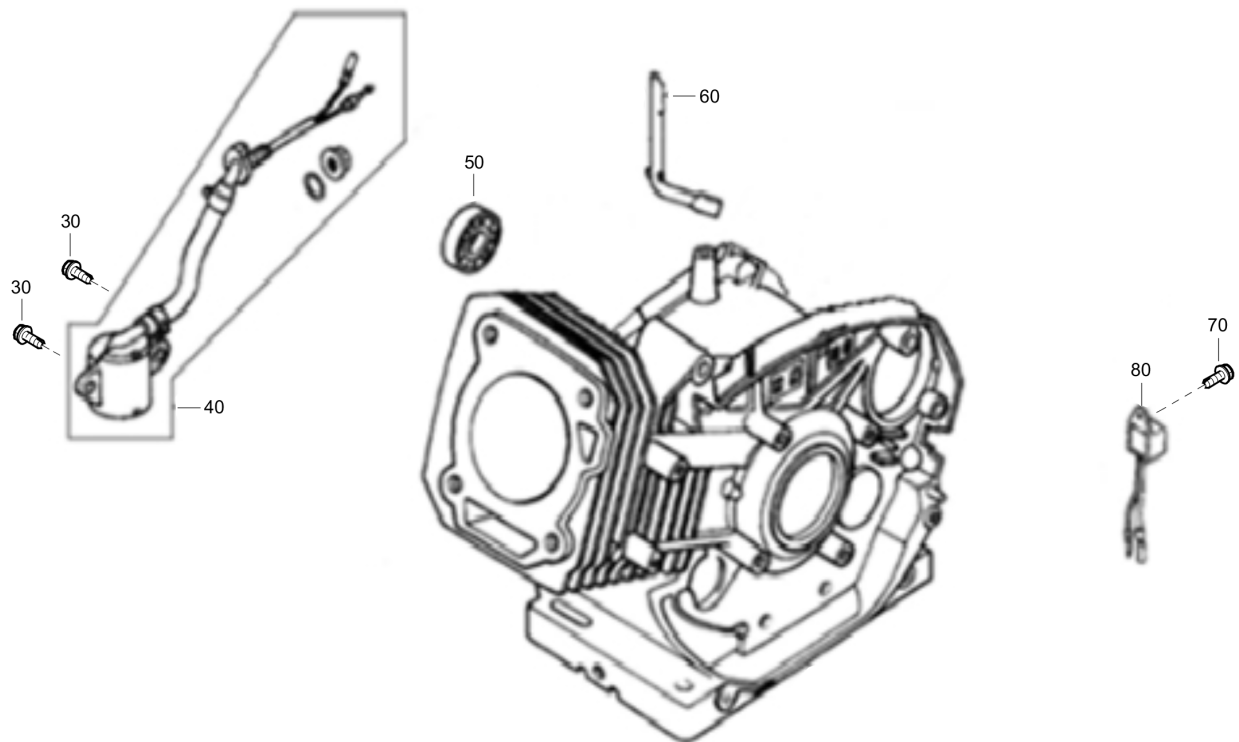
**Engine** Crankcase 220/110V

Item	Part No.	Name	Qty	L
30	1636303324	Hexagon bolt with flange	2	
40	1636300675	Oil level sensor	1	
50	1636300676	Bearing	1	
60	1636300677	Speed regulating arm	1	
70	1636302323	Hexagon bolt with flange	2	
80	1636302426	Engine oil protector	1	

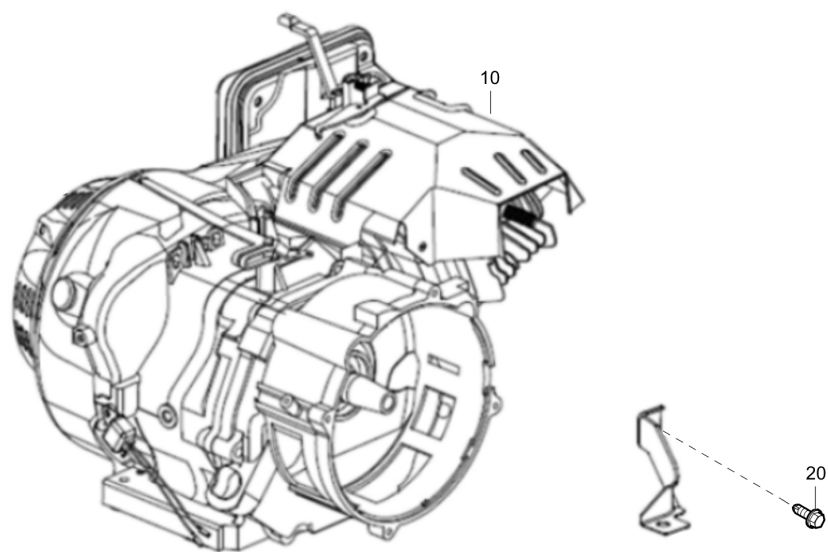
**Engine** Engine assembly 230V

Item	Part No.	Name	Qty	L
10	1636303304	Engine	1	
20	1636302323	Hexagon bolt with flange	1	

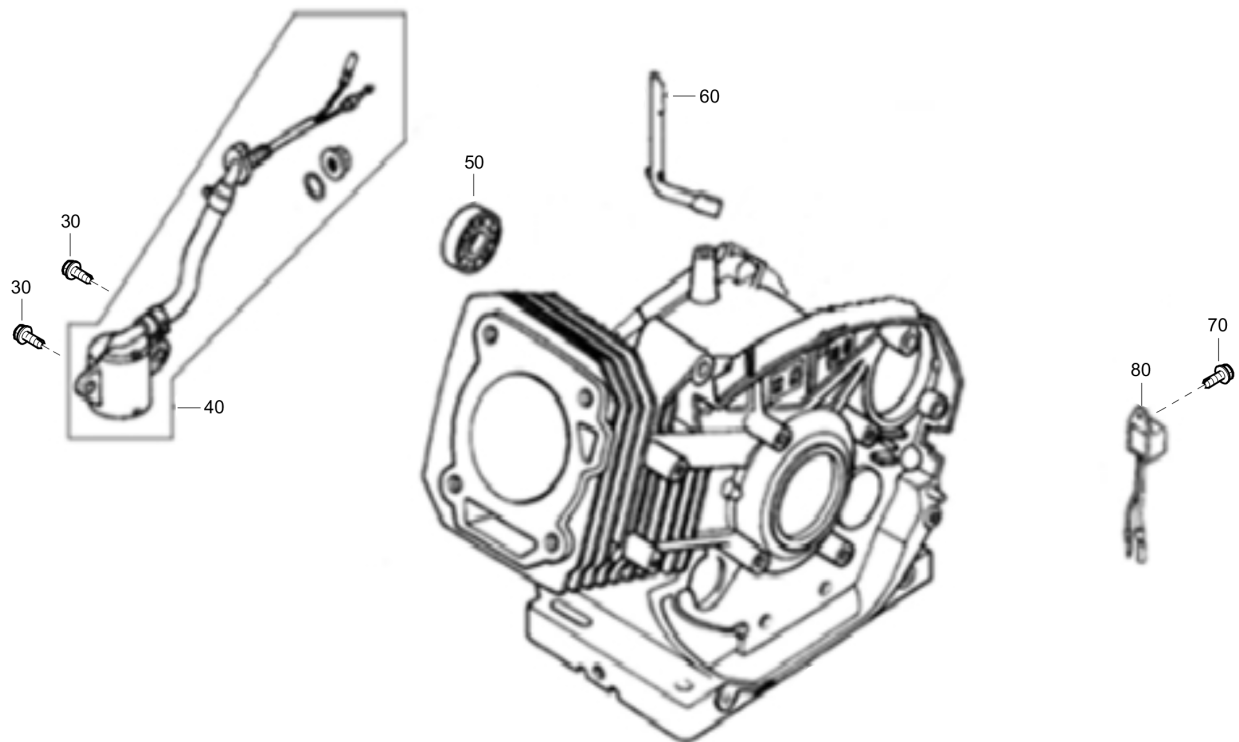
**Engine** Crankcase 230V

Item	Part No.	Name	Qty	L
30	1636303324	Hexagon bolt with flange	2	
40	1636300675	Oil level sensor	1	
50	1636300676	Bearing	1	
60	1636300677	Speed regulating arm	1	
70	1636302323	Hexagon bolt with flange	2	
80	1636300606	Engine oil protector	1	

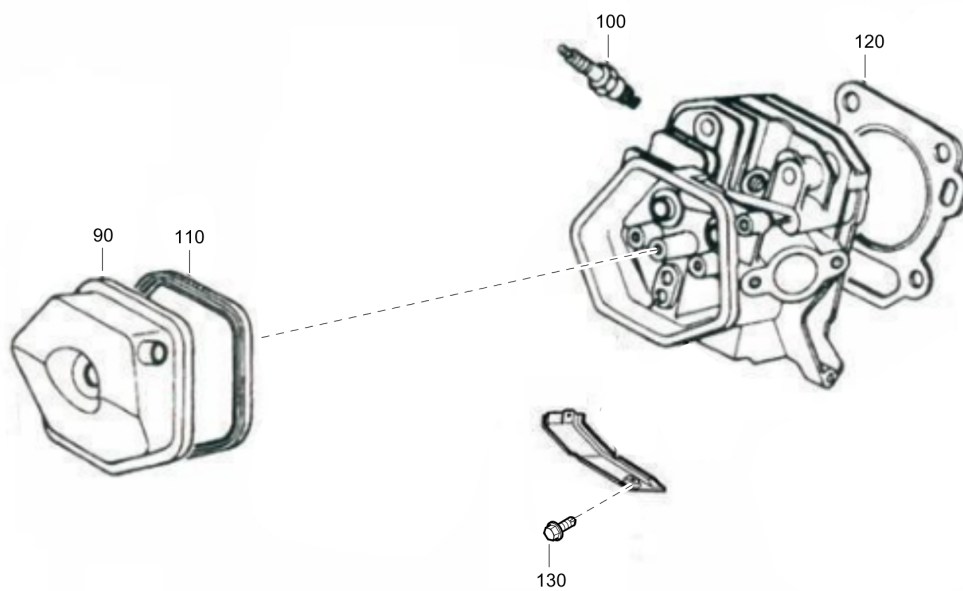

**Engine** Cylinder head

Item	Part No.	Name	Qty	L
90	1636300980	Cylinder head cover assembly	1	
100	1636300603	Spark plug	1	
110	1636300673	Rocker cover gasket	1	
120	1636300674	Gasket for cylinder head	1	
130	1636302323	Hexagon bolt with flange	1	

Engine Flywheel assembly

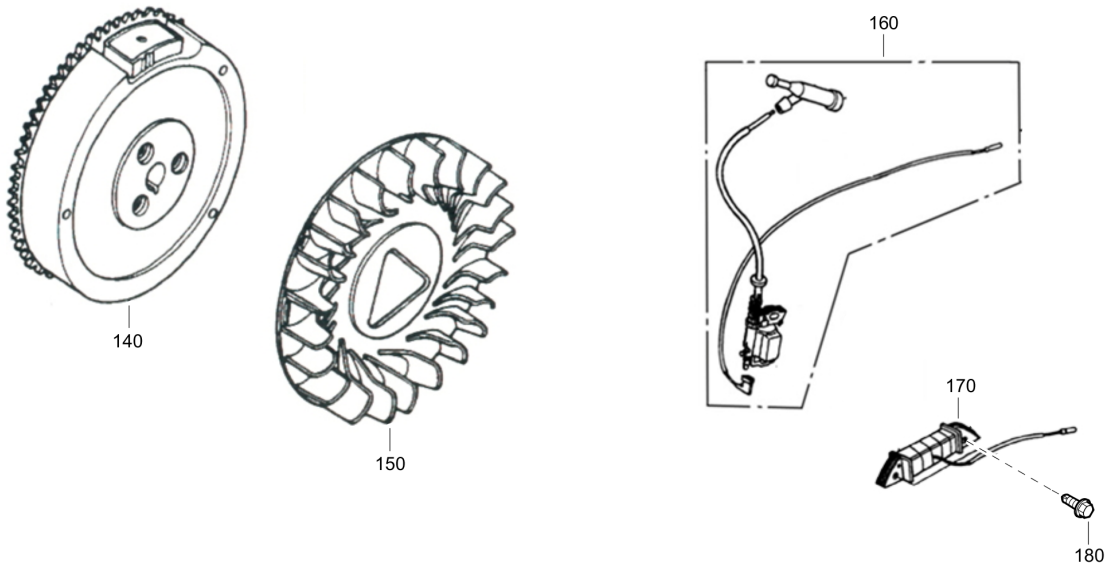

Item	Part No.	Name	Qty	L
140	1636301002	Flywheel component	1	
150	1636300698	Impeller	1	
160	1636303872	Coil assembly ignition	1	
170	1636300700	Components of charging current armature	1	
180	1636302323	Hexagon bolt with flange	1	

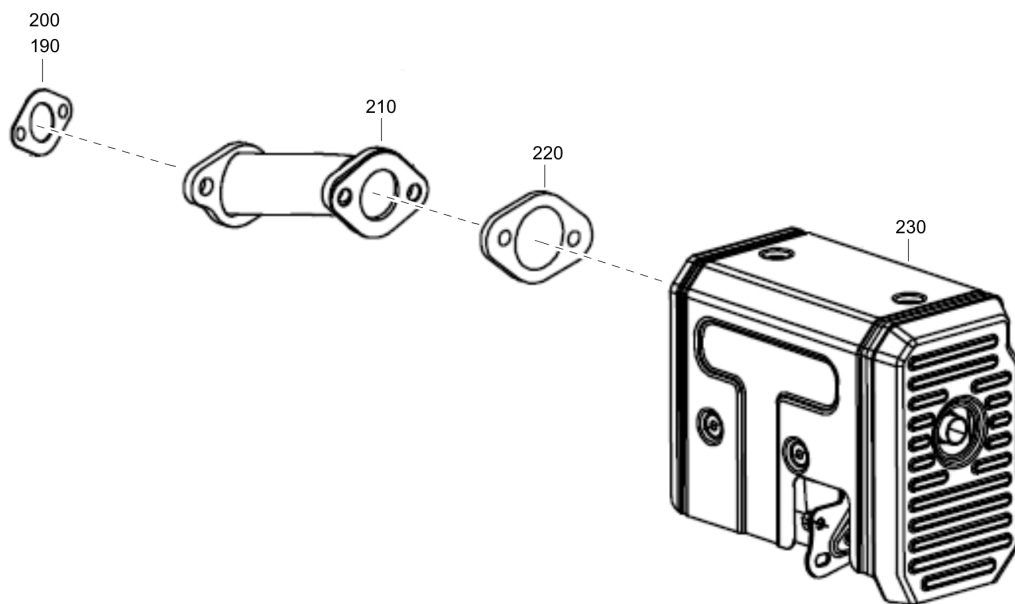
**Engine** Muffler assembly

Item	Part No.	Name	Qty	L
190	1636300709	Outlet gasket	1	
200	1636303878	Outlet gasket	1	
210	1636300710	Outlet pipe	1	
220	1636300711	Muffler gasket	1	
230	1636300712	Muffler	1	

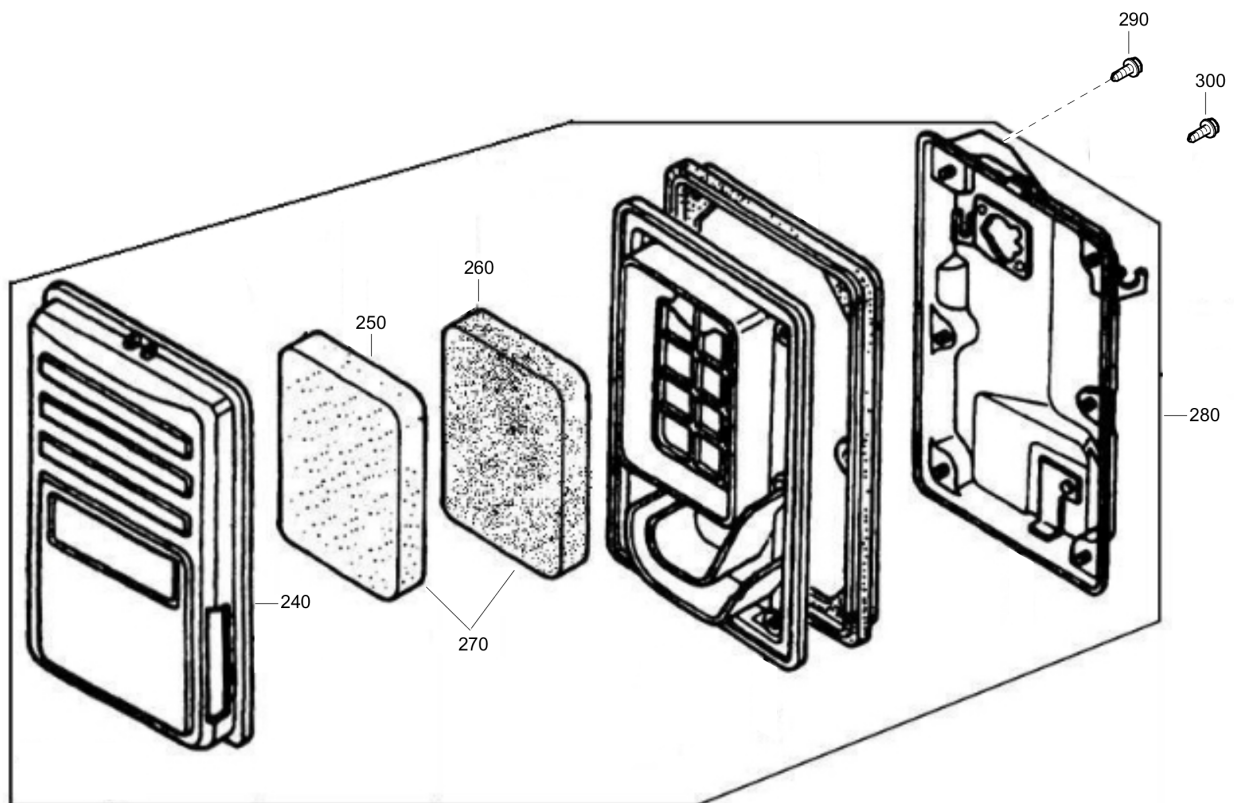
**Engine** Air cleaner assembly

Item	Part No.	Name	Qty	L
240	1636300701	Air filter casing cover	1	
250	1636300702	Air filter element	1	
260	1636300703	Air filter element	1	
270	1636300704	Air filter element combination	1	
280	1636300705	Air filter	1	
290	1636302285	Hexagon nut with flange	1	
300	1636302299	Hexagon nut with flange	1	

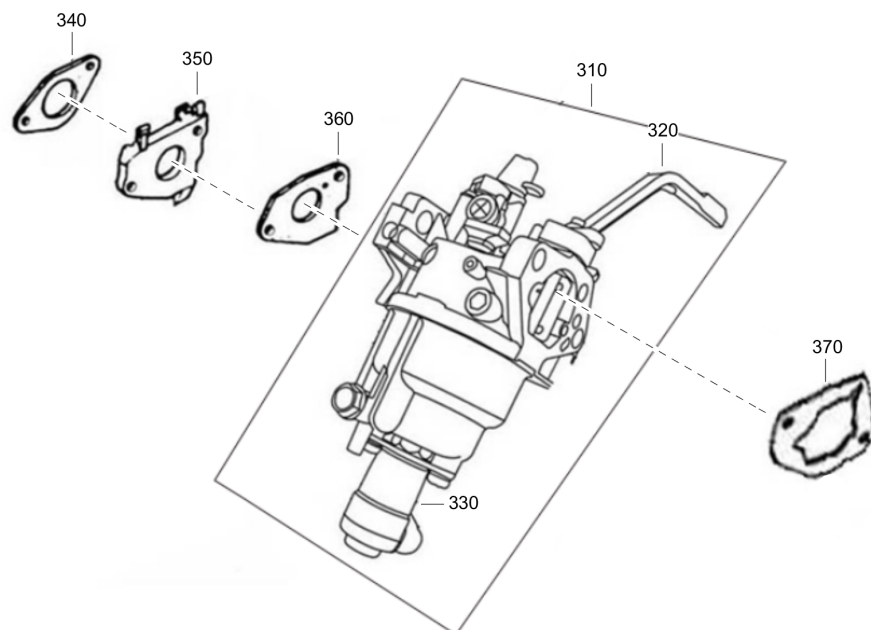

**Engine** Carburetor assembly

Item	Part No.	Name	Qty	L
310	1636304204	Carburetor	1	
320	1636300693	Choke valve handle combination	1	
330	1636304108	Solenoid valve	1	
340	1636300694	Carburetor gasket	1	
350	1636300695	Heat insulating pad for carburetor	1	
360	1636300696	Carburetor gasket	1	
370	1636300697	Carburetor gasket	1	

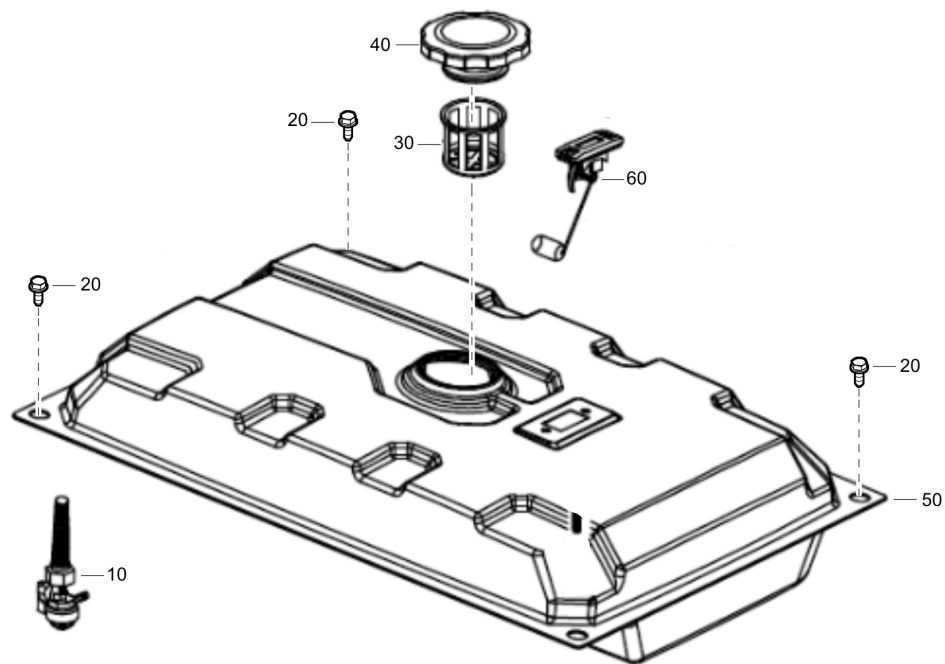
**Engine** Fuel tank

Item	Part No.	Name	Qty	L
10	1636300640	Components of oil switch	1	
20	1636302287	Hexagon bolt with flange	4	
30	1636300641	Pouring orifice filter screen combination	1	
40	1636302264	Tank cover	1	
50	1636301008	Fuel tank	1	
60	1636300643	Components of oil level	1	

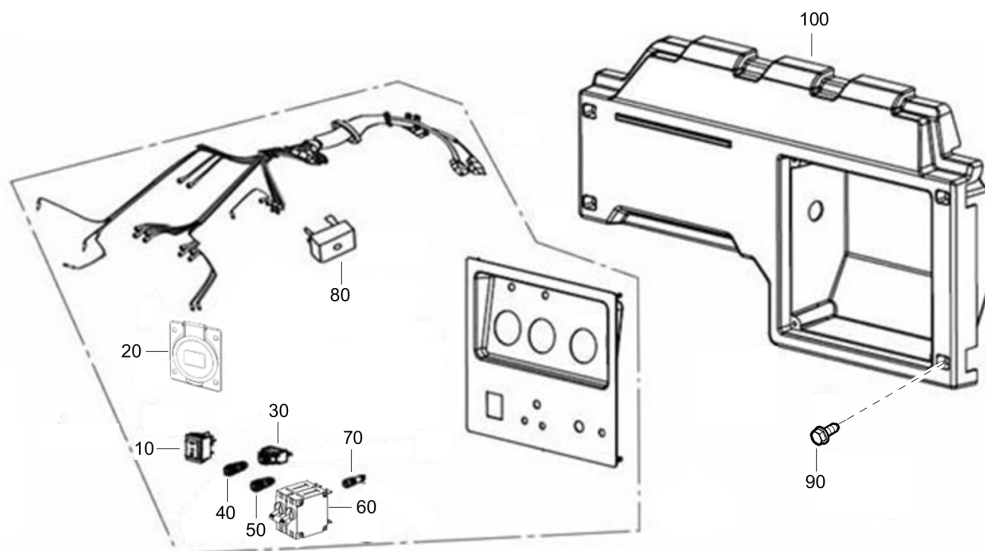
**Electric system** Control panel assembly 220/110V

Item	Part No.	Name	Qty	L
10	1636300724	Start control switch	1	
20	1636303323	Power socket combination	1	
30	1636300726	Overcurrent protector	1	
40	1636302271	Positive terminal combination	1	
50	1636302272	Negative terminal combination	1	
60	1636304208	Overcurrent protector	1	
70	1636302273	Panel output indicator light	1	
80	1636300650	Rectification bridge	1	
90	1636303324	Hexagon bolt with flange	4	
100	1636300728	Panel bed	1	

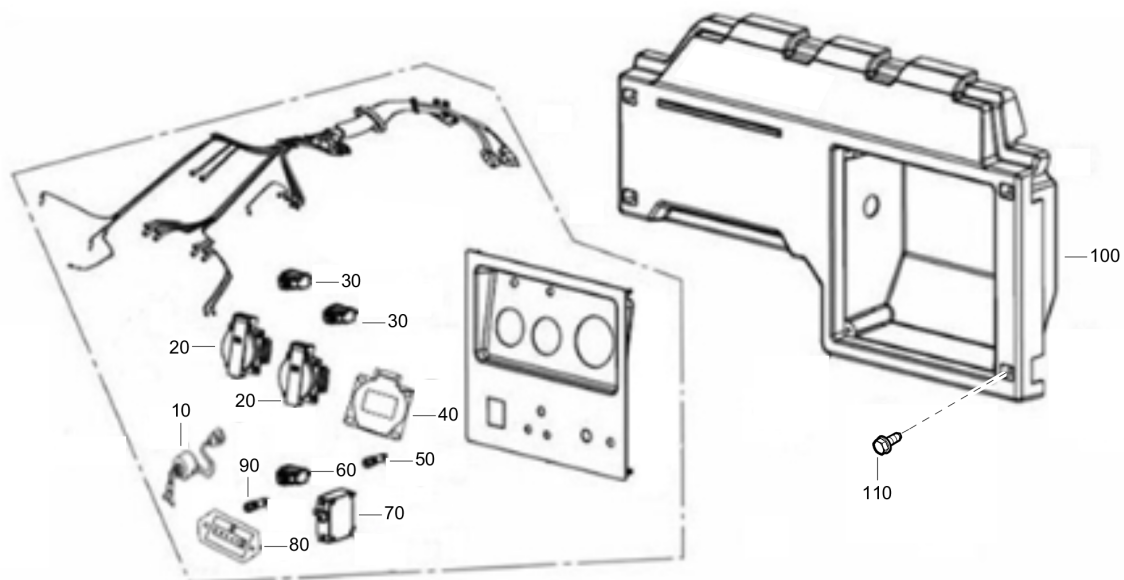
**Electric system** Control panel assembly 230V

Item	Part No.	Name	Qty	L
10	1636302270	Start control switch	1	
20	1636300961	Power socket combination	2	
30	1636300725	Overcurrent protector	2	
40	1636303323	Power socket combination	1	
50	1636302273	Panel output indicator light	1	
60	1636300726	Overcurrent protector	1	
70	1636300727	Overcurrent protector	1	
80	1636300652	Timer	1	
90	1636302274	Panel output indicator light	1	
100	1636300728	Panel bed	1	
110	1636303324	Hexagon bolt with flange	4	

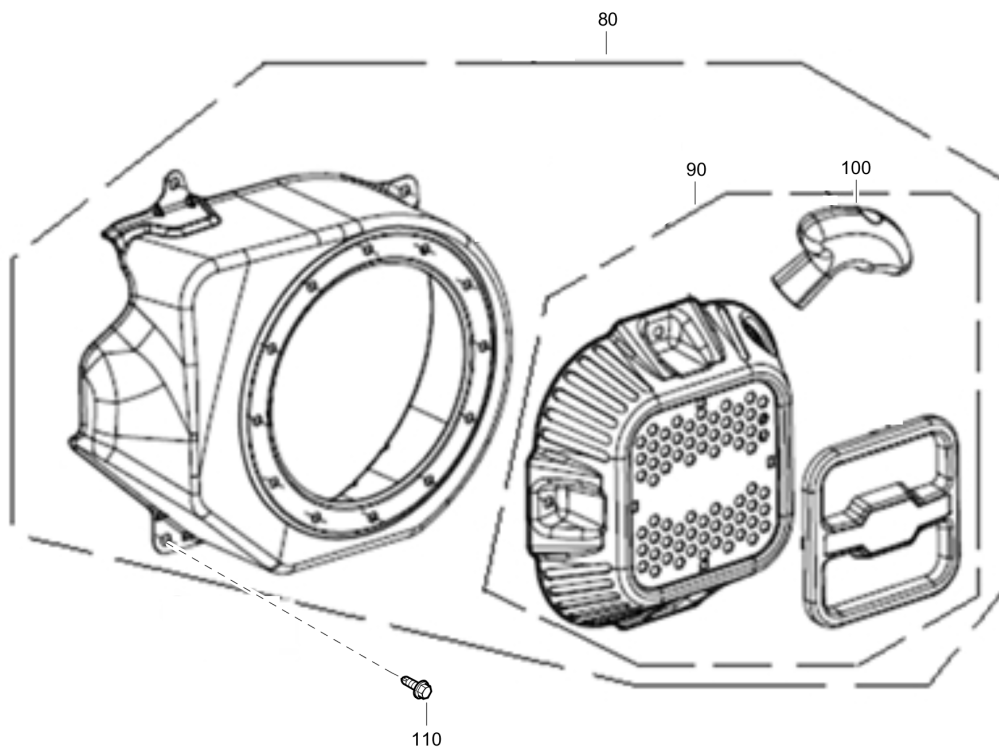

**Electric system** Starter assembly

Item	Part No.	Name	Qty	L
80	1636300998	Manual starting assembly	1	
90	1636300747	Manual starting components	1	
100	1636304205	Pull rope handle	1	
110	1636302323	Hexagon bolt with flange	5	

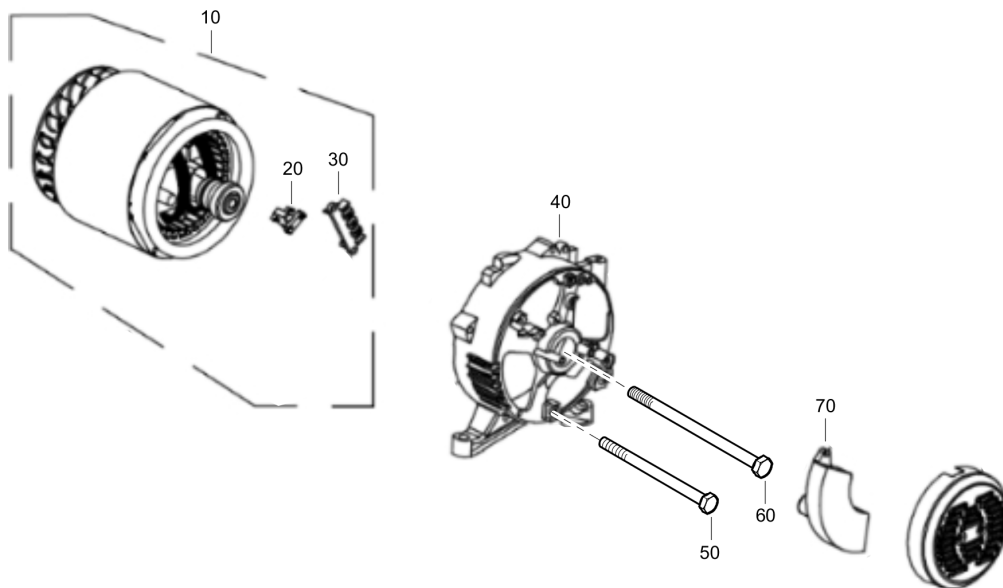
**Electric system** Alternator

Item	Part No.	Name	Qty	L
10	1636304207	Components of motor	1	
20	1636300715	Motor terminal plate	1	
30	1636300716	Carbon brush combination	1	
40	1636300717	Rear motor support	1	
50	1636302266	Hexagon bolt with flange	2	
60	1636300718	Hexagon bolt	1	
70	1636300719	Voltage regulator	1	